



CRYSTAL BALL CATALOG INDEX

Click on the desired line below and the program will take you to that page. If you don't see what you are looking for, scroll down that page.

Specifications

Gold Series Box Construction
Birch Door Profiles
Oak Door Profiles

Understanding Red Oak
Understanding Birch
Understanding Painted Finishes
Caring for Your Cabinetry

Wall Cabinets

21H, 24H, 27H, 30H, 36H, 42H
12H, 15H, 18H
24 Deep—15H, 18H, 24H, 27H, 30H
24 Deep—12H
Blind Corners
Wall Angle & Wall Lazy Susans
Peninsulas
Microwave Cabinets

Base Cabinets

Standard Bases
Sink Bases, Angled Sink Front
Drawer Bases
All-Door Bases
Peninsulas
Corner Bases
Lazy Susans
Super Susan & EZ Reach Corners
Trash Bin Base

Tall Cabinets

Utility Cabinets
Oven Cabinets

Vanity Cabinets

Vanity Drawer & Door Cabinets
Vanity All-Door Lavatory Cabinets
Vanity Sinks
Vanity Sink/Drawer Stack Combos
Vanity Sink/Door/Drawer Combos
Vanity Drawer Stacks
Tall Vanities, Tall Sinks, Tall Combos
Vanity Wall Cabinet

Accessories

Wine Racks
Valances
3/4" End Panels
Base End Panels
Fillers
Finished Backs
Shelf Kits
Toe Cover
End Skins
Moldings

Promotional Samples

Touch Up Materials

Modifications

November 2018

Gold Series Box Construction

Specifications are subject to change without notice.

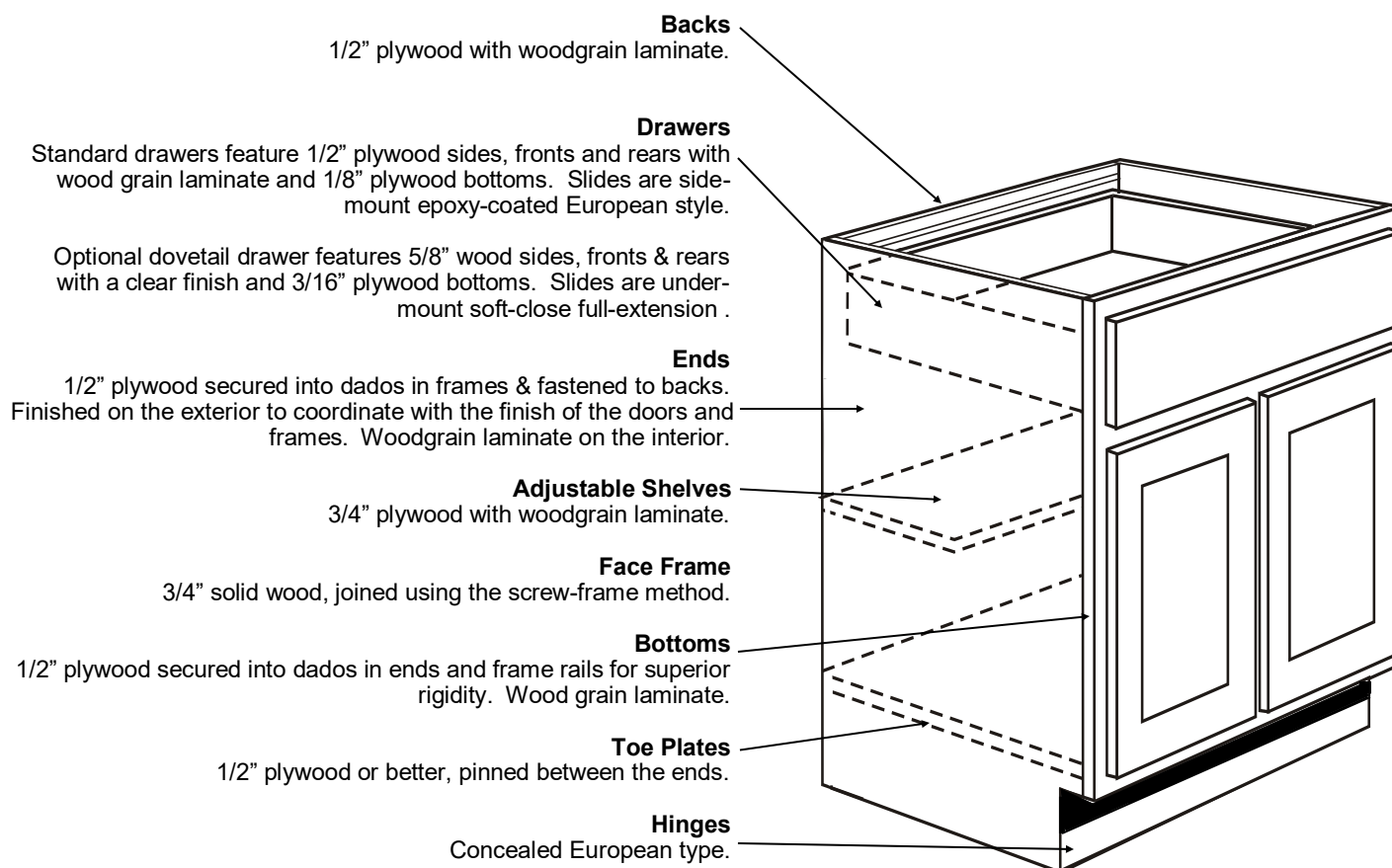
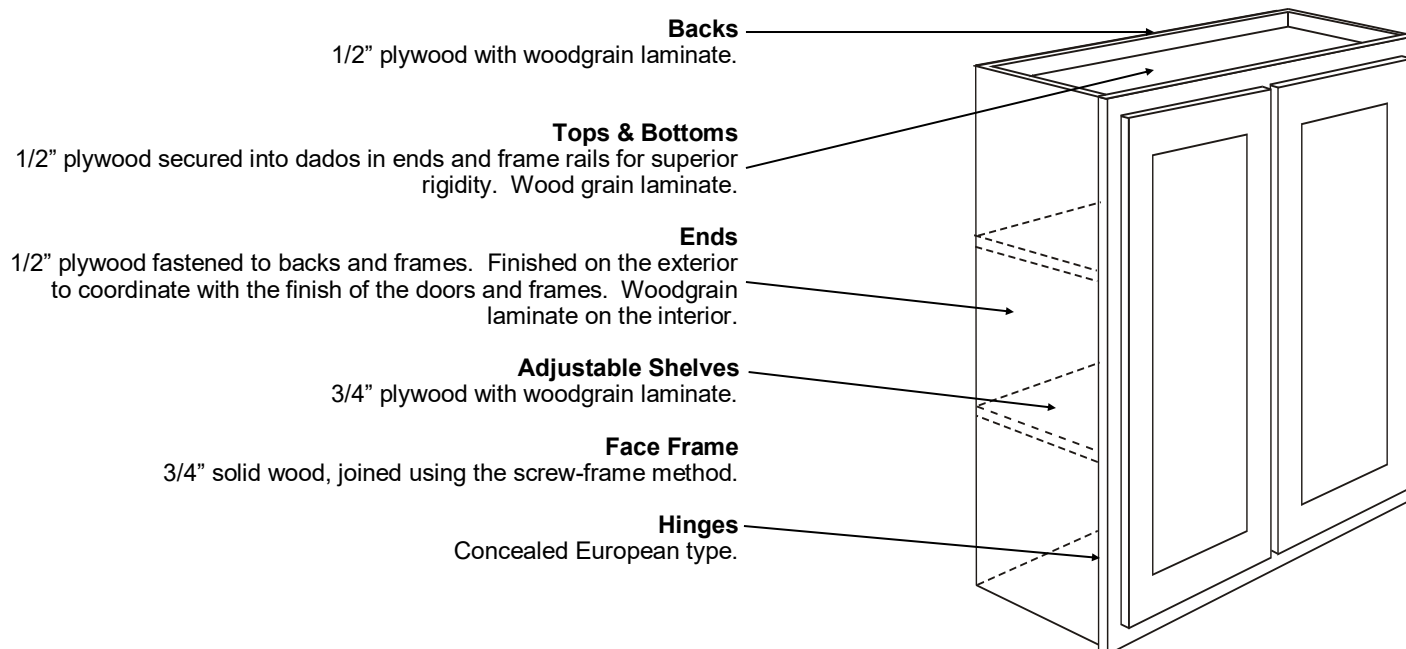

Door Style Profiles - Birch



FRANKLIN

Overlay: Full
Upper Door: Square
Drawer Front: 5 piece
Stile Width: 2 1/4"
Door Panel Thickness: 13mm
Drawer Front Panel Thickness: 1/2"

Door center panels primarily feature wood veneer over engineered Substrate. Some center panels may occasionally be of solid wood.



CANNES

Overlay: 1/2"
Upper Door: Square
Drawer Front: Slab
Stile Width: 2"
Door Panel Thickness: 13mm
Drawer Front Thickness: 3/4"

Door center panels primarily feature wood veneer over engineered Substrate. Some center panels may occasionally be of solid wood.



DURHAM

Overlay: 1/2"
Upper Door: Square
Drawer Front: Slab
Stile Width: 2"
Door Panel Thickness: 3/16"
Drawer Front Thickness: 3/4"



SCRANTON

Overlay: Full
Upper Door: Square
Drawer Front: Slab
Stile Width: 2 1/4"
Drawer Front Thickness: 3/4"



MALIBU

Overlay: Full
Upper Door: Square
Drawer Front: Slab
Drawer Front Thickness: 3/4"



PLYMOUTH

Overlay: Full
Upper Door: Square
Drawer Front: 5 piece
Stile Width: 2 1/4"
Door Panel Thickness: 3/16"
Drawer Front Panel Thickness: 1/2"

Door Style Profiles - Oak



BOSTON

Overlay: 1/2"

Upper Door:

Square

Drawer Front:

Slab

Stile Width:

2"

Door Panel

Thickness: 5/8"

Drawer Front

Thickness: 3/4"



Understanding Red Oak

Red oak lumber contains many characteristics which distinguish its beauty from that of other woods. Its wide, open, “flaming” grain patterns and its plentiful supply have made it an American favorite since revolutionary times.

Red oak, as with most other hardwoods, contains a variety of colors and tones. While red is the predominant color in red oak lumber, it is intermingled with shades of white, tan, brown, green, blue, and black. These colors appear randomly in any given piece of lumber. It is also important to remember that oak is not unlike other hardwoods. It will contain mineral streaks, small sound knots, and occasional worm holes. Grains may vary from even to wild.

When looking at finished oak cabinetry, you should expect to see several varying factors. Light areas and dark areas [caused by varying wood color] will be present. Softer areas will absorb more finish than hard areas, and may cast an uneven appearance. The end grains of oak, such as those found on the tops and bottoms of center panels in cabinet doors, will absorb a significantly greater amount of stain than the rest of the lumber, and will be darker in color.

Variations in wood color will be more noticeable in lighter, more translucent finishes, such as our natural and honey finishes. Uneven finish appearances, splotchiness and darker end grains will be more noticeable in darker finishes.

Because providing price-sensitive cabinetry is a core value of Oracle Cabinetry, the grades of wood used will be below that of many higher-end manufacturers and our allowable range of wood colors and characteristics will allow much greater variation than in higher-end cabinetry. Additionally, the standards set for the back sides of frames, doors and drawer fronts will be below those typically found in cabinetry with less sensitivity to pricing.

We bring these characteristics to your attention because the product sampling available to you may not provide you with an adequate idea of how an installed kitchen or bathroom vanity will appear. It is your responsibility to decide whether or not the natural characteristics of finished oak wood will satisfy you. Neither Oracle Cabinetry., nor any of our dealers may be held responsible for customer dissatisfaction, at any level, that results from the characteristics mentioned above.

I have read the following paragraphs, and am confident that I understand the visual characteristics of red oak lumber, both finished and unfinished. By signing below, I affirm that I do, in fact, seek these characteristics, and I agree not to hold Oracle Cabinetry nor any of its dealers or agents liable for any dissatisfaction which may occur as a result of these characteristics.

Printed Name: _____ Witness: _____

Signature: _____ Date: _____



Understanding Birch

Birch lumber contains many characteristics which distinguish its beauty from that of other woods. The surface appearance of birch is a combination of soft, flowing grains, intermingled with different patterns caused by varying density. The angle from which you view a given piece of finished birch lumber will also affect its color. The color often flips when you change the direction from which you view it.

Birch, as with other hardwoods, contains a variety of colors and tones. A combination of colors, ranging from a light whitish tone to a brown tone are commonly found in consumer products made from birch lumber. The birch lumber specified for our lines features a considerable variety of color in order that those lines can be offered to the consumer at a more affordable price. It is also important to remember that birch is not unlike other hardwoods. It will contain mineral streaks, small, sound knots, and occasional worm holes. Grains may vary from even to wild.

Our lines which specify Birch lumber also allow for the occasional inclusion of soft maple and other select hardwoods and hardwood veneers.

When looking at finished birch cabinetry, you should expect to see several varying factors. Light areas and dark areas will be present. The end grains of birch such as those found on the tops & bottoms of center panels in cabinet doors, can absorb a significantly greater amount of stain than the rest of the lumber, and may be darker in color. Birch veneers, such as those used in recessed center panels of doors, will absorb stains differently than solid wood and will thus tend to be a slightly different color than solid wood.

Variations in wood color will be more noticeable in lighter, more translucent finishes, such as our honey finish. Uneven finish appearances splotchiness and darker end grains will be more noticeable in darker, more heavily pigmented finishes. In painted finishes, the depth and pattern wood grain will commonly telegraph through the paint, causing some areas to appear textured, while some areas will appear more smooth.

Because providing price-sensitive cabinetry is a core value of Oracle Cabinetry, the grades of wood used will be below that of many higher-end manufacturers and our allowable range of wood colors and characteristics will allow much greater variation than in higher-end cabinetry. Additionally, the standards set for the back sides of frames, doors and drawer fronts will be below those typically found in cabinetry with less sensitivity to pricing.

We bring these characteristics to your attention because the product sampling available to you may not provide you with an adequate idea of how an installed kitchen or bathroom vanity will appear. It is your responsibility to decide whether or not the natural characteristics of finished birch wood will satisfy you. Neither Oracle Cabinetry., nor any of our dealers may be held responsible for customer dissatisfaction, at any level, that results from the characteristics mentioned above.

I have read the following paragraphs, and am confident that I understand the visual characteristics of birch lumber, both finished and unfinished. By signing below, I affirm that I do, in fact, seek these characteristics, and I agree not to hold Oracle Cabinetry nor any of its dealers or agents liable for any dissatisfaction which may occur as a result of these characteristics.

Printed Name: _____ Witness: _____

Signature: _____ Date: _____



Understanding Painted Finishes

Oracle Cabinetry has gone to great measures to design our white lines of cabinetry to be as price sensitive as possible, while still using painted wood and plywood doors and drawer fronts instead of thermofoil-covered particleboard or MDF doors.

Opaque finishes, such as painted finishes on wood, tend to magnify certain characteristics which are common to finished wood products. For example, the grain of the wood will often telegraph through paint, creating a textured appearance. Also, joints in doors and face frames will often show as visible lines—these are very obvious with painted finishes. In order to keep the price as reasonable as possible, small imperfections such as dents and splits may be visible through the paint and/or laminate, and may need to be touched up in the field.

Variations in atmospheric conditions at the time the paint was applied, combined with variations of hardness and softness in the grain of the wood will also cause the texture of the paint itself to vary. It may be silky smooth in some places and have an eggshell texture in other places.

When viewing a sampling of our white cabinetry, you may have noticed that the doors and sides of the cabinets feature a painted finish, while the sides and interiors feature a laminate finish. The two are similar in color, but are not the same color.

We bring these characteristics to your attention because the product sampling available to you may not provide you with an adequate idea of how an installed kitchen or bathroom vanity will appear. It is your responsibility to decide whether or not the natural characteristics of painted wood products will satisfy you. Neither Oracle Cabinetry nor any of our dealers may be held responsible for customer dissatisfaction, at any level, that results from the characteristics mentioned above.

I have read the following paragraphs, and am confident that I understand the visual characteristics of painted finishes on wood. By signing below, I affirm that I do, in fact, seek these characteristics, and I do agree not to hold Oracle Cabinetry, nor any of its dealers or agents liable for any dissatisfaction which may occur as a result of these characteristics.

Printed Name: _____ Witness: _____

Signature: _____ Date: _____



Caring for Your Cabinetry

Wood Finishes

Dust

Dust often with a soft, lint-free cloth. If you wish, you may dampen cloth slightly with water or commercial spray dust remover.

Clean

Always clean spills immediately, using a clean cloth, you may use a mild soap if necessary. Dry with a clean, dry cloth.

For cleaning there are several fine commercial products available: for instance, Guardsman, an excellent cleaner, is readily available in stores nationwide.

To remove grease buildup, Fantastik is cheap and effective. Spray on cloth and wipe cabinets quickly then rewipe with another damp cloth to remove any cleaner. Dry cabinets and apply a silicone-free polish.

Polish

You only need to wash and polish cabinets once or twice a year. Use a high-quality furniture polish. Apply sparingly.

Please Note:

Do not use steel wool, soap pads or detergents on cabinets or you will mar the finish.

Do not use waxes or polishes containing silicone. Wax buildup is very difficult to remove and the residue attracts dust.

Shelving

The shelves are rated for a static load of 15 lbs per square foot, evenly distributed.

In order to achieve this rating, shelves that are found in cabinets 30" and wider must be braced with a screw-in shelf support, **after the consumer has adjusted them to their desired positions.**

Because the consumer ultimately decides where to position adjustable shelves within the cabinets, **the consumer is responsible** for purchasing and installing these supports, and for making certain not to exceed the load rating.

If you need shelf supports, or have any questions about shelf supports or shelf load ratings, please call us at 800.410.2444.

Preventive Care

Self-Cleaning Ovens

Finishes of cabinets which have been installed adjacent to self-cleaning ovens are at risk from escaping heat if the oven's heat gasket has failed. During an oven's cleaning cycle we recommend you remove all doors and drawers from cabinets which are above, below and beside the oven.

Heat-producing Appliances

Coffee makers, toaster ovens and similar appliances are best not placed underneath cabinets where the heat and moisture they produce may cause damage to cabinet finishes.



Wall Cabinets

42" HIGH – SINGLE DOOR

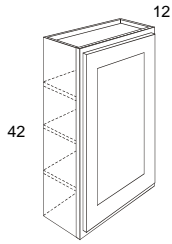

W0942
W1242
W1542
W1842
W2142

36" HIGH – TWO DOORS

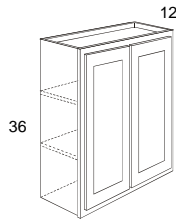

W2436
W2736
W3036
W3336
W3636
W4236

27" HIGH - TWO DOORS

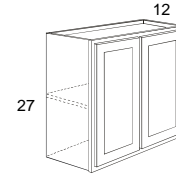

W3027
W3627

42" HIGH – TWO DOORS

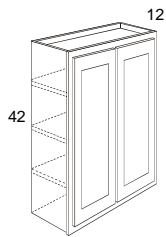

W2442
W2742
W3042
W3342
W3642
W4242

30" HIGH – SINGLE DOOR

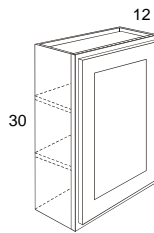

W0930
W1230
W1530
W1830
W2130

24" HIGH - TWO DOORS

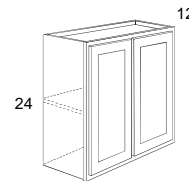

W2424
W3024
W3324
W3624
W3924
W4224

36" HIGH – SINGLE DOOR

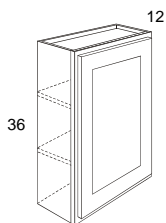

W0936
W1236
W1536
W1836
W2136

30" HIGH - TWO DOORS

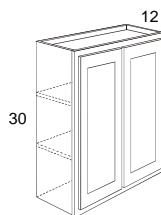

W2430
W2730
W3030
W3330
W3630
W3930
W4230
W4530
W4830 (4 doors)

21" HIGH - TWO DOORS

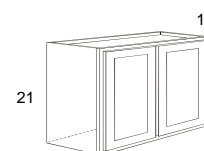

W3021
W3621

Standard cabinets 9-21 wide have 1 door (hinge left), 24-36 wide have 2 butt doors, 39-45 wide have 2 doors and a center mull, & 48 wide have 2 pairs of butt doors and a center mull.

Wall Cabinets

18" HIGH - TWO DOORS

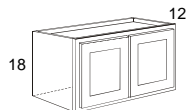

**W2418
W3018
W3318
W3618
W3918**

**30" HIGH – 24" DEEP
TWO DOORS**

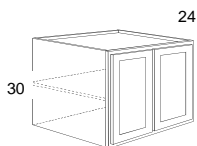

**W3030-24D
W3330-24D
W3630-24D
W3930-24D
W4230-24D
W4830-24D***

**21" HIGH – 24" DEEP
TWO DOORS**

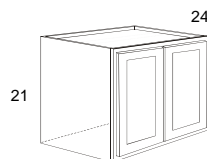

**W3021-24D
W3621-24D**

**4 doors*

15" HIGH - TWO DOORS

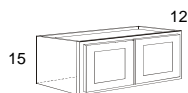

**W3015
W3315
W3615
W3915**

**27" HIGH – 24" DEEP
TWO DOORS**

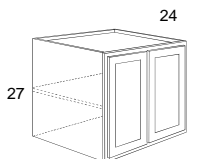

**W3027-24D
W3627-24D**

**18" HIGH – 24" DEEP
TWO DOORS**

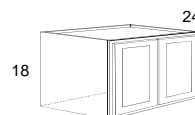

**W3018-24D
W3318-24D
W3618-24D
W3918-24D**

12" HIGH - TWO DOORS



**W3012
W3612
W3912-6M***

**24" HIGH – 24" DEEP
TWO DOORS**

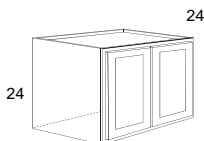

**W3024-24D
W3324-24D
W3624-24D
W3924-24D
W4224-24D**

**15" HIGH – 24" DEEP
TWO DOORS**

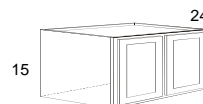

**W3015-24D
W3315-24D
W3615-24D
W3915-24D**

**6" center mull & extra 3" reveal*

Standard cabinets 9-21 wide have 1 door (hinge left), 24-36 wide have 2 butt doors, 39-45 wide have 2 doors and a center mull, & 48 wide have 2 pairs of butt doors and a center mull.

**12" HIGH – 24" DEEP
TWO DOORS**



**W3012-24D
W3612-24D
W3912-24D-6M***

**6" mull and 3" extra reveal*

**REVERSIBLE BLIND CORNER CABINET
INSTALLATION INFORMATION**

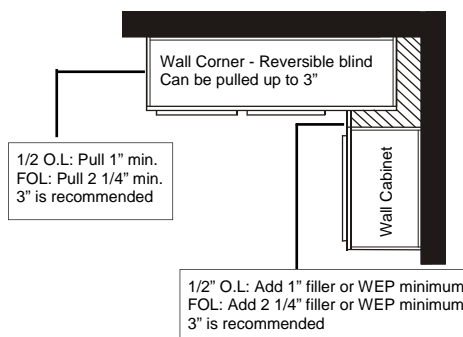

**REVERSIBLE BLIND CORNER
42" HIGH - SINGLE DOOR**

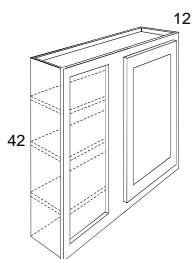

**WC2442 (12)
WC2742 (15)
WC3042 (18)
WC3342 (21)**

**REVERSIBLE BLIND CORNER
36" HIGH - SINGLE DOOR**

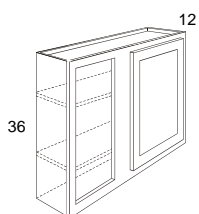

**WC2436 (12)
WC2736 (15)
WC3036 (18)
WC3336 (21)**

**REVERSIBLE BLIND CORNER
30" HIGH - SINGLE DOOR**

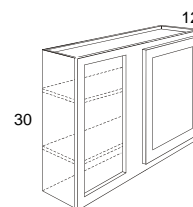

**WC2430 (12)
WC2730 (15)
WC3030 (18)
WC3330 (21)**

**REVERSIBLE BLIND CORNER
42" HIGH - TWO DOORS**

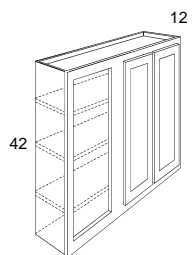

**WC3642 (24)
WC3942 (27)
WC4242 (30)**

**REVERSIBLE
36" HIGH - TWO DOORS**

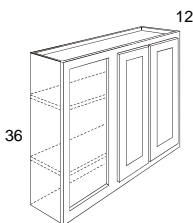

**WC3636 (24)
WC3936 (27)
WC4236 (30)**

**REVERSIBLE BLIND CORNER
30" HIGH - TWO DOORS**

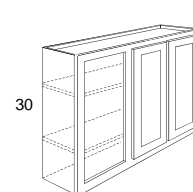

**WC3630 (24)
WC3930 (27)
WC4230 (30)
WC4530 (33)
WC4830 (36)**

Standard cabinets 9-21 wide have 1 door (hinge left), 24-36 wide have 2 butt doors, 39-45 wide have 2 doors and a center mull, & 48 wide have 2 pairs of butt doors and a center mull.

Wall Cabinets

42" HIGH - WALL ANGLE

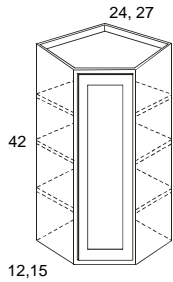

**WA42
WA42-15D**

42" HIGH - LAZY SUSAN

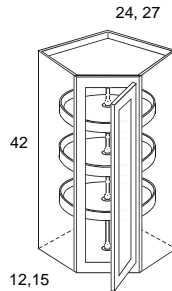

**WLS42
WLS42-15D**

**30" HIGH - PENINSULA
TWO DOORS**

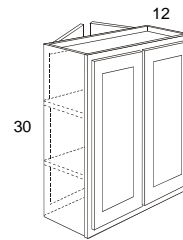

**WP3030
WP3630
WP4230**

36" HIGH - WALL ANGLE

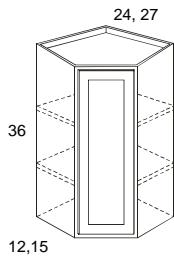

**WA36
WA36-15D**

36" HIGH - LAZY SUSAN

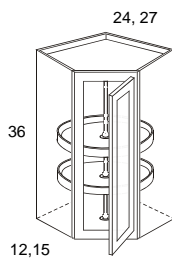

**WLS36
WLS36-15D**

**24" HIGH - PENINSULA
TWO DOORS**

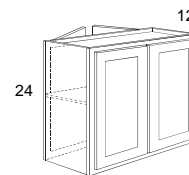

**WP3024
WP3624**

30" HIGH - WALL ANGLE

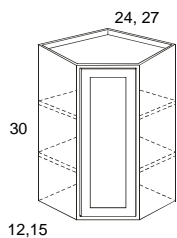

**WA30
WA30-15D**

30" HIGH - LAZY SUSAN

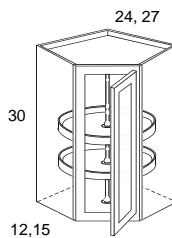

**WLS30
WLS30-15D**

MICROWAVE CABINETS

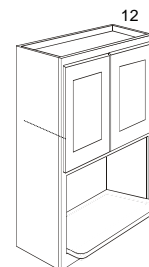

MWS2736
Opening 24W x 15 1/2H

MWS3036
Opening 27W x 18 1/2H

MWS3045
Opening 27W x 18 1/2H

Opening heights
shown are after the
shelf is installed

NOTES:
Matching interior
Shim at rear 1/8" to level
Top portion of MWS2736 same as 18H cabinet
Top portion of MWS3036 same as 15H cabinet
Top portion of MWS3045 same as 24H cabinet

Base Cabinets

**STANDARD BASE
SINGLE DOOR - ONE DRAWER**

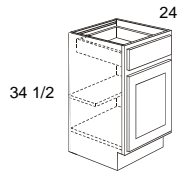

**B09
B12
B15
B18
B21**

**SINK BASE
TWO DOORS - ONE FRONT**

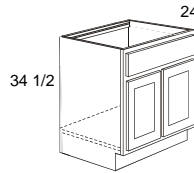

**BS24
BS27
BS30
BS33
BS36**

DIAGONAL SINK FRONT

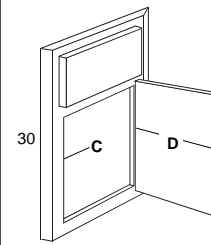

ASF 42x42

LEGEND
 A: OVERALL FRAME
 B: EXPOSED FRAME
 C: ROUGH OPENING
 D: DOOR WIDTH

ASF 42 x 42
 A. 27"
 B. 25 1/2"
 C. 19 1/2"
 D. 20 1/2"

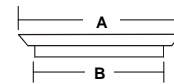

**STANDARD BASE
TWO DOORS - ONE DRAWER**

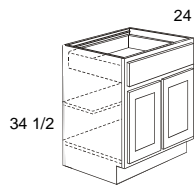

**B24
B27
B30
B33
B36**

**SINK BASE
TWO DOORS - TWO FRONTS**

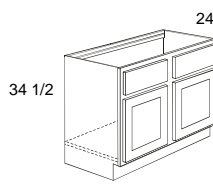

**BS39
BS42
BS45
BS48 (4 doors)**

NOTES:
 Includes: [1] sink front, [1] 1/2" printed particle-board 47 7/8" x 47 7/8", which must be field cut for the bottom & a toe kick.

Features 3 3/4" stiles, installs to cabinets set 42" from corners.

**STANDARD BASE
TWO DOORS - TWO DRAWERS**

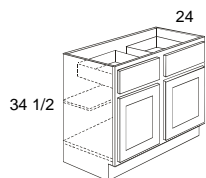

**B39
B42
B45
B48 (4 doors)**

Standard cabinets 9-21 wide have 1 door (hinge left), 24-36 wide have 2 butt doors, 39-45 wide have 2 doors and a center mull, & 48 wide have 2 pairs of butt doors and a center mull.

Base Cabinets

FOUR DRAWER BASES

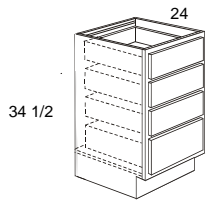

**BDT12
BDT15
BDT18
BDT21
BDT24**

PENINSULA BASES

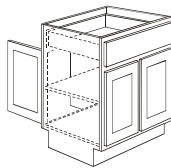

BP36

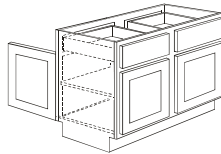

**BP42
BP48 (4 doors)**

REVERSIBLE CORNER BASES

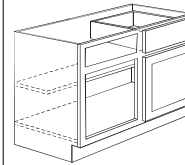

**BBR21
BBR27
BBR33
BBR39
BBR45**

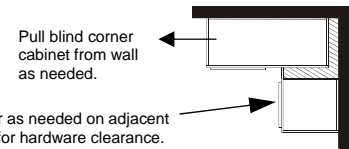

Cabinet	Covers	Door/Drw For
BBR21	34"-37 1/2"	B09
BBR27	37"-40 1/2"	B12
BBR33	40"-43 1/2"	B15
BBR39	43"-46 1/2"	B18
BBR45	46"-49 1/2"	B21

BASE ALL DOOR SINGLE DOOR

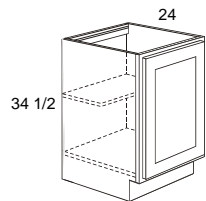

**BAD15
BAD18
BAD21**

1/2" OVERLAY REVOLVING CORNER BASE

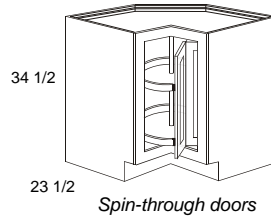

BLS

Plan View

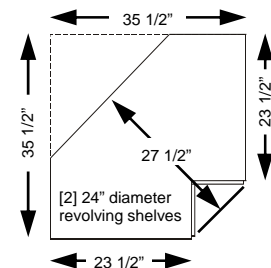

NOTES:
Doors attach to pie-cut susan & rotate inside cabinet.
Shelf material: white polymer
Finished ends are not available

BASE ALL DOOR TWO DOORS

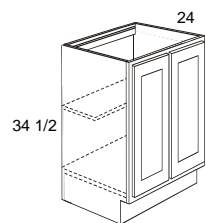

**BAD24
BAD27
BAD30
BAD33
BAD36
BAD39
BAD42
BAD45
BAD48 (4 doors)**

FULL-OVERLAY REVOLVING CORNER BASE

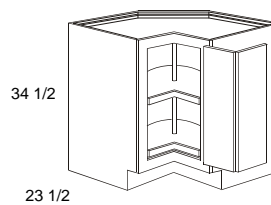

BLS-FOL

Plan View

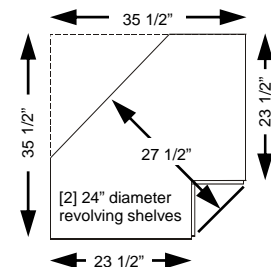

NOTES:
Specify hinge side. Doors are piano-hinged together. Two kidney, 24" diameter white polymer revolving shelves
Finished ends are not available

Standard cabinets 9-21 wide have 1 door (hinge left), 24-36 wide have 2 butt doors, 39-45 wide have 2 doors and a center mull, & 48 wide have 2 pairs of butt doors and a center mull.

SUPER SUSAN CORNER BASE

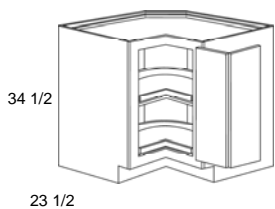

34 1/2"

23 1/2"

SSB

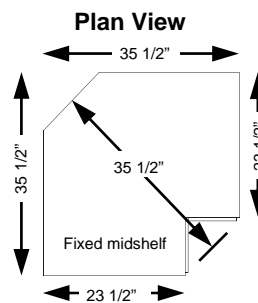

NOTES:

Specify hinge side. Doors are piano-hinged together. Full overlay door styles use 1/2" overlay hinges and the frame on hinge side is notched for hinge placement. This cabinet is thus cosmetically unsuitable for use without doors. Two independently-rotating wood shelves mounted on fixed shelves. Will not fit through openings smaller than 34 1/2". Finished ends are not available

EZ REACH CORNER BASE

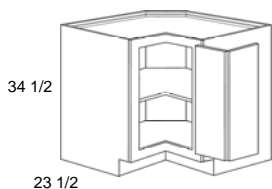

34 1/2"

23 1/2"

ERB

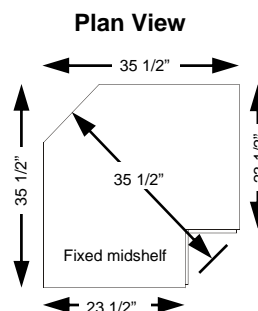

NOTES:

Specify hinge side. Doors are piano-hinged. Full overlay door styles use 1/2" overlay hinges and the frame on hinge side is notched for hinge placement. This cabinet is thus cosmetically unsuitable for use without doors. Will not fit through openings smaller than 34 1/2". Finished ends are not available.

BASE CABINET WITH 1 DOOR-MOUNT TRASH CAN

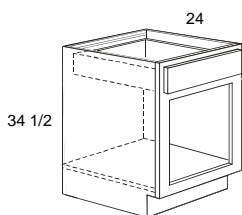

34 1/2"

24"

B1TC18



NOTES:

Trash Can is factory installed.

Standard cabinets 9-21 wide have 1 door (hinge left), 24-36 wide have 2 butt doors, 39-45 wide have 2 doors and a center mull, & 48 wide have 2 pairs of butt doors and a center mull.

Tall Cabinets

**91 1/2" HIGH - 12" & 24" DEEP
SINGLE DOOR**

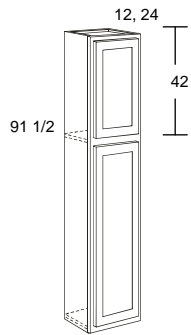

U181291 1/2
U182491 1/2

NOTES:
1 fixed shelf, 7 adjustable shelves
Pre-assembled toe base is shipped separately.

**91 1/2" HIGH - 12" & 24" DEEP
TWO DOORS**

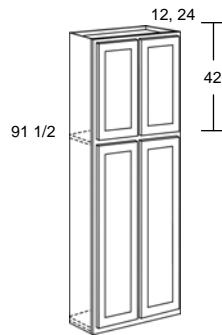

U241291 1/2
U242491 1/2

NOTES:
1 fixed shelf, 7 adjustable shelves
Pre-assembled toe base is shipped separately.

UNIVERSAL OVEN CABINETS

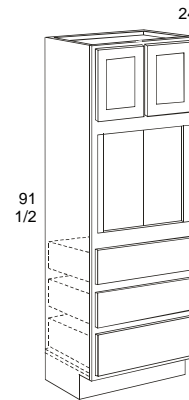

***OU2791 1/2**
***OU3091 1/2**
***OU3391 1/2**

OU2790
OU3090
OU3390

OU2784
OU3084
OU3384

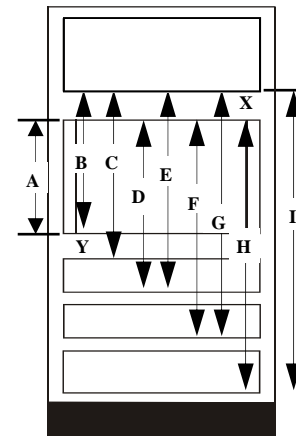

RAIL X = Width 9 1/4"
RAIL Y = Width 9 1/4"

Width Cutout Guide

	<u>MIN.</u>	<u>MAX.</u>
*OU2791 1/2	21"	25"
*OU3091 1/2	24"	28"
*OU3391 1/2	27"	31"
OU2790	21"	25"
OU3090	24"	28"
OU3390	27"	31"
OU2784	21"	25"
OU3084	24"	28"
OU3384	27"	31"

**90" HIGH - 12" & 24" DEEP
SINGLE DOOR**

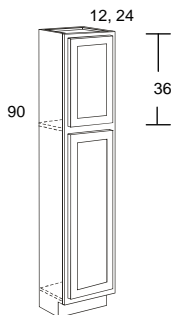

U181290
U182490

NOTES:
1 fixed shelf, 6 adjustable shelves

**90" HIGH - 12" & 24" DEEP
TWO DOORS**

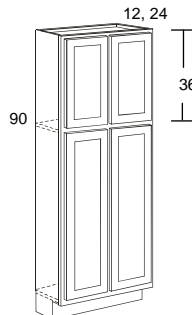

U241290
U242490

NOTES:
1 fixed shelf, 6 adjustable shelves

**84" HIGH - 12" & 24" DEEP
SINGLE DOOR**

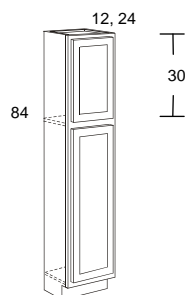

U181284
U182484

NOTES:
1 fixed shelf, 6 adjustable shelves

**84" HIGH - 12" & 24" DEEP
TWO DOORS**

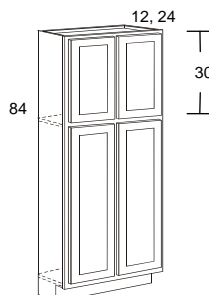

U241284
U242484

NOTES:
1 fixed shelf, 6 adjustable shelves

1/2 Overlay Opening Height Cutout Guide

- A. 22 1/2" minimum opening
- B. 31" maximum - trim "X" rail
- C. 39 1/2" maximum - trim rails "X" and "Y"
- D. 36 3/4" minimum - remove drawer 1
- E. 44 3/4" maximum - remove drawer 1 - trim rail "X"
- F. 43" minimum - remove drawers 1 & 2
- G. 51" maximum - remove drawers 1 & 2 - trim rail "X"
- H. 52 1/4" minimum - remove all drawers

Full Overlay Opening Height Cutout Guide

- A. 22 1/2" minimum opening
- B. 30 1/2" maximum - trim "X" rail
- C. 38" maximum - trim rails "X" and "Y"
- D. 36 3/4" minimum - remove drawer 1
- E. 44 1/4" maximum - remove drawer 1 - trim rail "X"
- F. 43" minimum - remove drawers 1 & 2
- G. 50 1/2" maximum - remove drawers 1 & 2 - trim rail "X"
- H. 52 1/4" minimum - remove all drawers
- I. 59 3/4" maximum - remove all drawers - trim rail "X"

Standard cabinets 9-21 wide have 1 door (hinge left), 24-36 wide have 2 butt doors, 39-45 wide have 2 doors and a center mull, & 48 wide have 2 pairs of butt doors and a center mull.

Vanity Cabinets

STANDARD VANITY SINGLE DOOR - ONE DRAWER

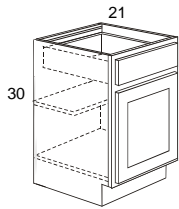

**V12
V15
V18**

NOTES:
Standard height vanity cabinets feature 3" bottom rails and 1 1/2" additional frame reveal at the bottom.

VANITY DRAWER TIER SINKS SINGLE DOOR

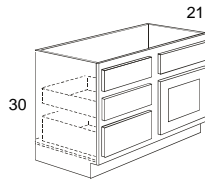

**VDTS30-L
[shown]**

**VDTS30-R
[opposite]**

**VDTS36-L
[shown]**

**VDTS36-R
[opposite]**

NOTES:
2 false fronts. Door hinged to outside. Standard height vanity cabinets feature 3" bottom rails and 1 1/2" additional frame reveal at the bottom.

COMBO CENTER VANITY

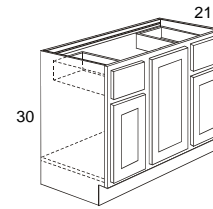

**VDL42
VDL48
VDL54**

NOTES:
In 1/2" overlay Heritage lines, doors are 1/2" different in height than door/drawer front combinations. Standard height vanity cabinets feature 3" bottom rails and 1 1/2" additional frame reveal at the bottom.

VANITY LAVATORY TWO DOORS

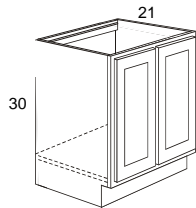

**VL24
VL27
VL30
VL33
VL36
VL42
VL48 (4 doors)**

NOTES:
In 1/2" overlay, doors are 1/2" different in height than door/drawer front combinations. Standard height vanity cabinets feature 3" bottom rails and 1 1/2" additional frame reveal at the bottom.

VANITY DRAWER TIER SINK TWO DRAWER STACKS

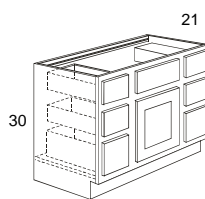

VDTS48

NOTES:
Standard height vanity cabinets feature 3" bottom rails and 1 1/2" additional frame reveal at the bottom.

COMBO CENTER VANITIES

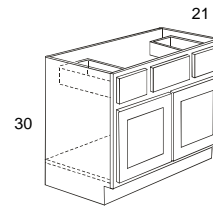

VDS36

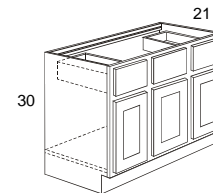

**VDS42
VDS48
VDS54**

VANITY SINK TWO DOORS

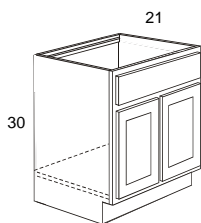

**VS24
VS27
VS30
VS33
VS36**

NOTES:
Standard height vanity cabinets feature 3" bottom rails and 1 1/2" additional frame reveal at the bottom.

DOUBLE BOWL VANITY W/DRAWERS

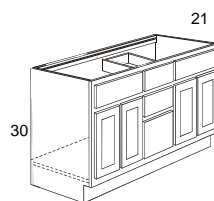

VDB60

NOTES:
Standard height vanity cabinets feature 3" bottom rails and 1 1/2" additional frame reveal at the bottom.

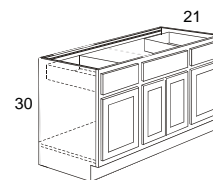

VDS60

NOTES:
Standard height vanity cabinets feature 3" bottom rails and 1 1/2" additional frame reveal at the bottom.

Standard cabinets 9-21 wide have 1 door (hinge left), 24-36 wide have 2 butt doors, 39-45 wide have 2 doors and a center mull, & 48 wide have 2 pairs of butt doors and a center mull.

Vanity Cabinets

VANITY DRAWER TIER

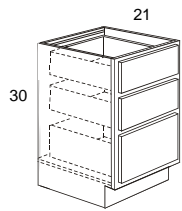

VDT15
VDT18
VDT21
VDT24

NOTES:
Standard height vanity cabinets feature 3" bottom rails and 1 1/2" additional frame reveal at the bottom.

TALL VANITY SINK TWO DOORS - ONE FRONT

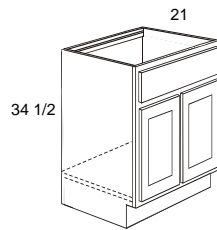

BS24-21D
BS27-21D
BS30-21D
BS33-21D
BS36-21D

NOTES:
Tall vanity cabinets feature standard 1 3/4" bottom rails & show approx. 1 1/2" less frame reveal than standard height vanity cabinets.

TALL VANITY SINK COMBOS

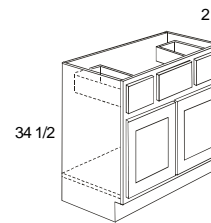

BDS36-21D

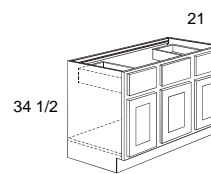

BDS42-21D
BDS48-21D
BDS54-21D

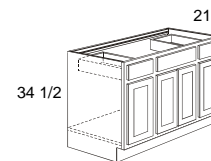

BDS60-21D

NOTES:
Tall vanity cabinets feature standard 1 3/4" bottom rails & 1 1/4" less frame reveal than standard height vanity cabinets.

VANITY KNEE DRAWER



VKD24
VKD27
VKD30
VKD33
VKD36

NOTES:
Not trimmable—order to desired width.

TALL VANITY SINK FOUR DOORS - TWO FRONTS

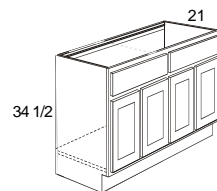

BS48-21D

NOTES:
Tall vanity cabinets feature standard 1 3/4" bottom rails & show approx. 1 1/2" less frame reveal than standard height vanity cabinets.

TALL VANITY SINGLE DOOR - ONE DRAWER

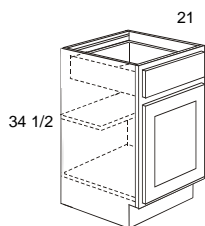

B12-21D
B15-21D
B18-21D

NOTES:
Tall vanity cabinets feature standard 1 3/4" bottom rails & show approx. 1 1/2" less frame reveal than standard height vanity cabinets.

TALL VANITY DRAWER TIER

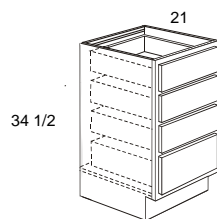

BDT12-21D
BDT15-21D
BDT18-21D
BDT21-21D
BDT24-21D

NOTES:
Tall vanity cabinets feature standard 1 3/4" bottom rails & show approx. 1 1/2" less frame reveal than standard height vanity cabinets.

TALL VANITY DRAWER SINK COMBO - ONE DOOR

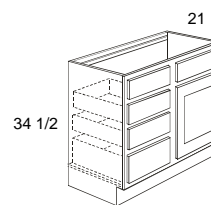

BDTS30-21D-R
BDTS30-21D-L
BDTS36-21D-R
BDTS36-21D-L

NOTES:
Left [L] is shown
Tall vanity cabinets feature standard 1 3/4" bottom rails & 1 1/4" less frame reveal than standard height vanity cabinets.

Vanity Cabinets

TALL VANITY DOUBLE BOWL COMBO

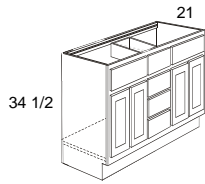

BDB60-21D

NOTES:

Tall vanity cabinets feature standard 1 3/4" bottom rails & 1 1/4" less frame reveal than standard height vanity cabinets.

WALL BATH SHELF

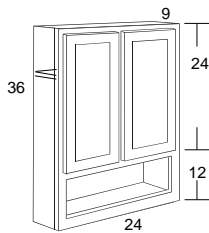

WBS24936

Standard cabinets 9-21 wide have 1 door (hinge left), 24-36 wide have 2 butt doors, 39-45 wide have 2 doors and a center mull, & 48 wide have 2 pairs of butt doors and a center mull.

Accessories

WINE RACKS

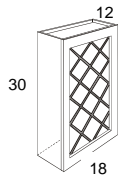

WR1830
WR2430
WR3615

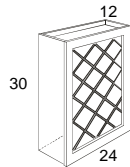
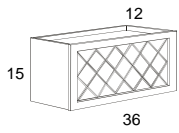

NOTES:
Matching Wood Interior - Lattice is maple
WR1830-10 Bottle Unit
WR2430-16 Bottle Unit
WR3615-14 Bottle Unit

BASE END PANEL

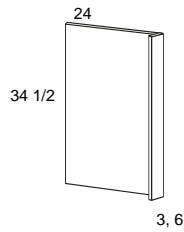

BEP3 PLY
BEP3 - PB

BEP 6 PLY
BEP6 - PB

FINISHED BACKS

FB48x96 (3/16 finished plywood)
FB48x96-HONEY (laminated on 2.7mm ply)
FB48x96-SPICE (laminated on 2.7mm ply)
FB48x96-EARTH (laminated on 2.7mm ply)
FB48x96-COFFEE (laminated on 2.7mm ply)
FB48x96-NATURAL (laminated on mdf)
FB48x96-WHITE

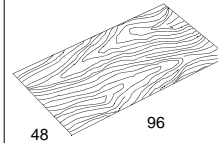

NOTES:
Finishing Note: 1" x 96" on one edge FB48x96 will not be usable. This is where the finishing hooks must be placed.

STRAIGHT VALANCE

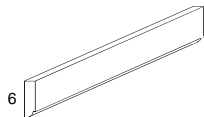

VAL48
VAL72

LOOSE FILLERS

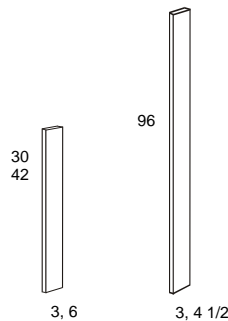

WF3 x 30
WF3 x 42
WF6 x 30
WF6 x 42

FF3 x 96
FF4 1/2 x 96

UTILITY SHELF KIT

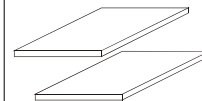

USK18
USK18-12D
USK24
USK24-12D

NOTES:
Includes 2 shelves.
3/4" thick

PLYWOOD END PANEL

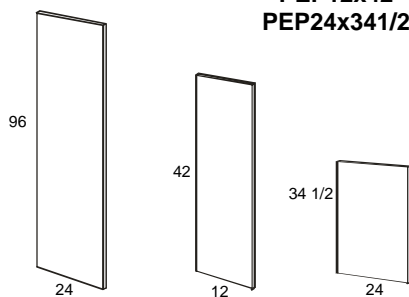

PEP24x96
PEP12x42
PEP24x341/2

NOTES:
Thickness: 3/4"
Finished on both sides.
Edgebanded and finished on one long edge

ANGLED FILLER

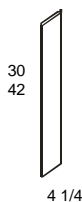

AF 4 1/4 x 30
AF 4 1/4 x 42

TOE COVER



PLYTOE
WHITE TOE
BLACK TOE

END SKINS

**WES42-PLY
WES-(color)
BES-PLY
BES-(color)
UES24x96-PLY
UES24x96-(color)**

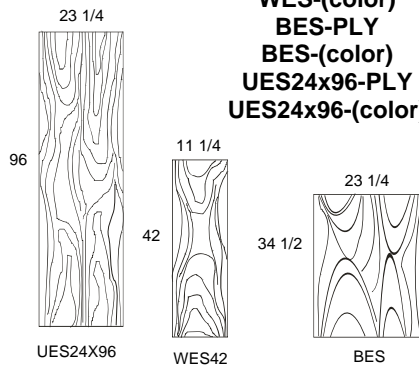

NOTES:
Plywood End Skins are 3/16" thick & oversized with holes drilled on top to allow finishing. End skins listed by color are laminated on plywood or mdf, depending on laminate color..

BAR BRACE

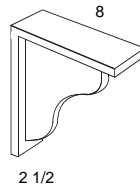

BARBR

NOTES:
Sold single

REFRIGERATOR END PANEL

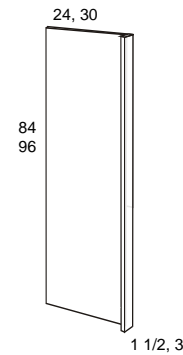

**REP1 1/2x24x84
REP1 1/2x24x96
REP1 1/2x30x96**

REP3x24x96

NOTES:
Plywood ends in wood lines
Melamine ends in white lines
Ends are finished on both sides

ADJUSTABLE MDF ROLLOUT KIT

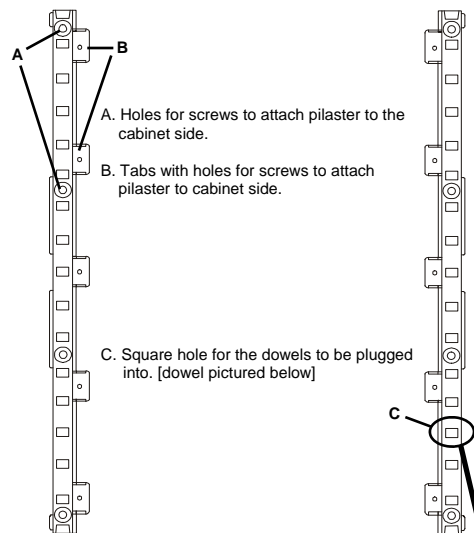

**ARK15
ARK18
ARK21
ARK24
ARK27
ARK30
ARK36**

NOTES:
Kit includes:
[4] white polymer Pilasters 20 1/8" H
[2] drawers with slides attached
[2] pairs of cabinet member slides with dowels attached.
Fiber drawers and side-mount drawer slides
Must be customer installed
Only fits 24" deep cabinets—cannot be modified.

DRAWER BOX WIDTHS

ARK15	9 1/2"
ARK18	12 1/2"
ARK21	15 1/2"
ARK24	18 1/2"
ARK27	21 1/2"
ARK30	24 1/2"
ARK36	30 1/2"

A dowel is affixed to the back of the cabinet members of the drawer slides. These dowels are snapped into the square holes [C] in the pilasters.

Dowels have a raised lip that keep them secured to the pilasters and an elongated surface that allows for automatic adjustment.

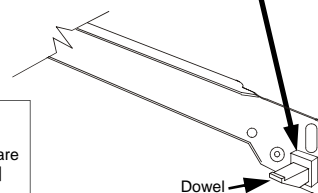

NOTES:
In the Crystal Ball Pricing program, ARKs can be chosen for either the bronze or Gold box, but only if the standard drawer is chosen. If you are ordering cabinets with the upgraded drawers, simply set up another room in the pricing program to order ARKs. In all cases, the drawer boxes will be MDF with side-mount slides.

24" Deep Utility Rollout Kit
Order ARK15 - ARK30 depending on width.
Pantry Rollout Kit
Lower Section: Order [2] ROK36

Instructions:
Install 4 posts on the bottom of the cabinet, then stack the next four posts on top of the first four posts.

Moldings

INSERT CROWN MOULDING

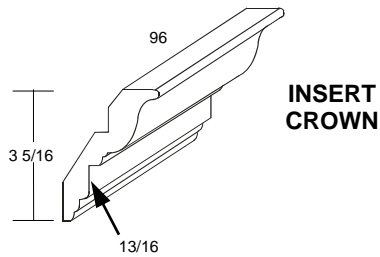

NOTES:
Projection: 2 7/16"
Mouldings to use with insert: Dentil, Rope

DECORATIVE COVE MOULDING

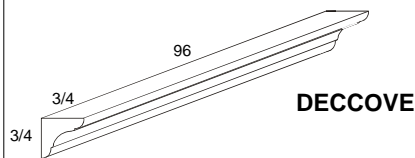

1/4 ROUND MOULDING

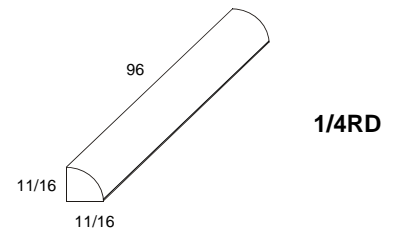

LARGE CROWN MOULDING

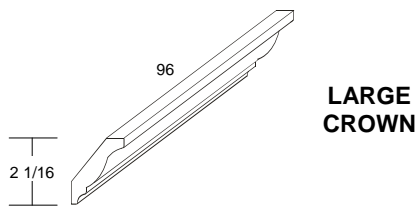

NOTES:
Projection: 1 3/4"

SCREEN MOULDING

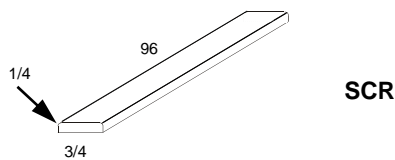

NOTES:
Both edges rounded.

OUTSIDE CORNER MOULDING

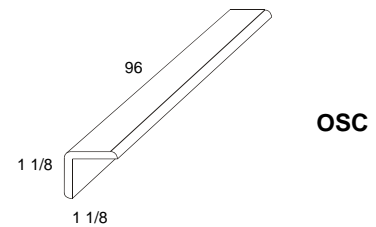

SMALL CROWN MOULDING

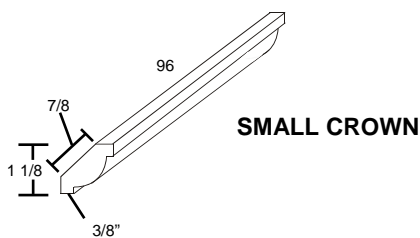

NOTES:
Projection: 1 1/8"

SCRIBE MOULDING

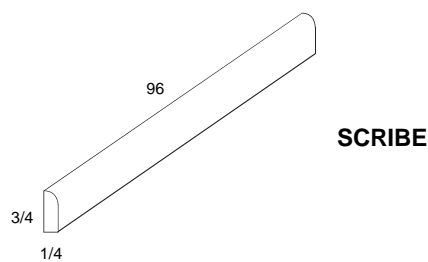

NOTES:
One edge rounded, one edge square
Projection: 1/4"

TRADITIONAL LIGHT RAIL

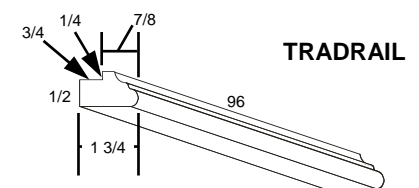

TRADRAIL

Moldings, Promotional Samples & Touch Up

DENTIL INSERT MOULDING

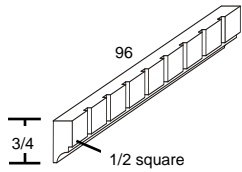

DENTIL

NOTES:
Projection: 1/2"
Fits on our insert crown.

DOOR SAMPLE

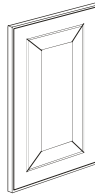

DS

TOUCH UP KIT

**TUK-SPICE
TUK-EARTH
TUK-HONEY
TUK-NATURAL
TUK-COFFEE
TUK-WHITE**

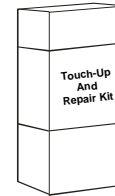

NOTES:
Kit includes: Marker, Fil Stick, Buffing Sponges
Not available in all finishes, call Customer Support or consult Smart Pricing for available finishes.

ROPE MOULDING

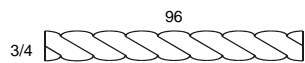

ROPE

NOTES:
Projection: 3/8"
Fits on our insert crown.

SAMPLE FRONT

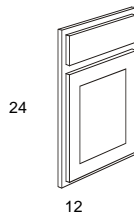

SF

NOTES:
Cartoned

AEROSOL - STAIN/SEALER COMBO



**ACAN-HONEY
ACAN-SPICE
ACAN-EARTH
ACAN-COFFEE
ACAN-NAT**

COLOR BLOCKS

**FULL SET
CBORACLE**



**BIRCH SINGLES
CB-BR-WHI-OR**
Crystal White

CB-BR-NAT-OR
Birch Natural

CB-BR-HON-OR
Birch Honey

CB-BR-SPI-OR
Birch Spice

**OAK SINGLES
CB-BR-WHI-OR**
Crystal White

CB-BR-NAT-OR
Birch Natural

CB-BR-EAR-OR
Birch Earth

CB-BR-HON-OR
Birch Honey

CB-BR-COF-OR
Birch Coffee

MINI BASE

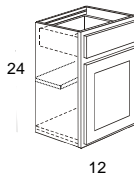

MB

AEROSOL - TOPCOAT

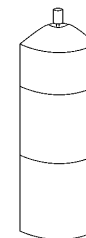

ACAN-HISHEEN

Modifications

REDUCE DEPTH

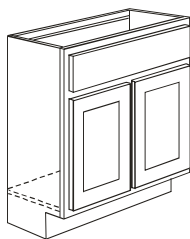

Available for straight cabinets in 1" increments. Full extension drawer slides cannot be reduced. When depth is reduced, standard undermount or side mount slides will be used & the full extension upcharge will still apply.

INCREASE DEPTH

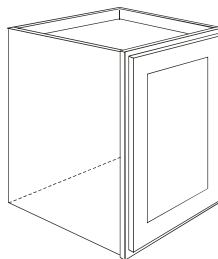

Available for straight cabinets in 1" increments. 24" Maximum

CABINET FRONT ONLY

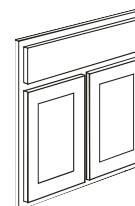

Available for most straight cabinets.